



1 FILL UP

Place the batteries into the cap. If needed, label the bottle with your pill name and other information on the enclosed sticker. Put your pills in the pill bottle.

Each day your GlowCap will pulse orange and play a melody to remind you.

To open, push down and turn

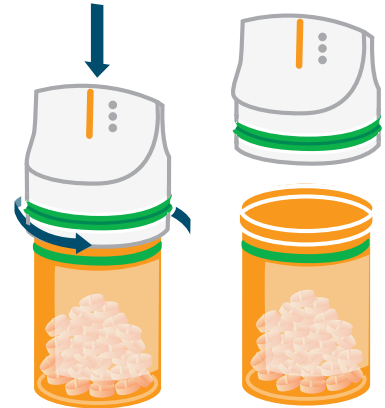

2 PLUG IN

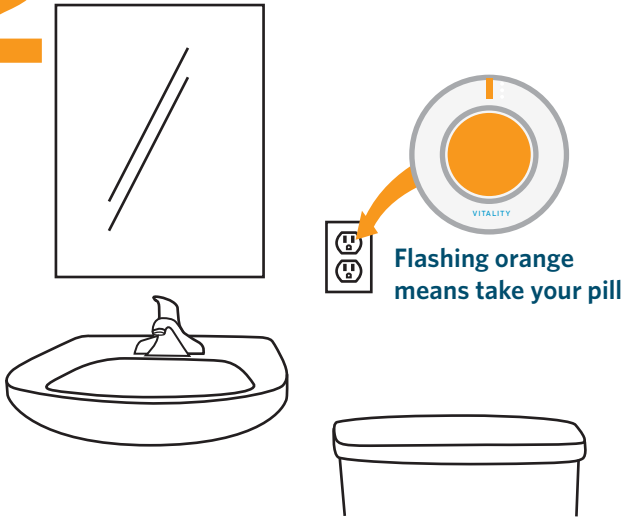

Find a counter-level power outlet (in your bathroom or kitchen) close to where you keep your pills.

Plug in the Reminder Light. It will glow blue and make a startup sound.

3 GET CONNECTED

Connect the Vitality Gateway to your Internet router with the enclosed red ethernet cable to your internet router.

If your Vitality Gateway is red, please call customer service at 1-866-389-8686

If your Vitality Gateway is green, you're connected

